

MATERIAL NUMBER	ENGINEERING NUMBER	WIRE RANGE	"L" MAX	"A" MIN	"B" MAX	MATERIAL	MATERIAL THICKNESS	TEMPERATURE RATING
192030165	A-T-302	22-18 (0.3-1.0mm <sup>2</sup> )	.330 / (8.4)	.060 / (1.5)	.130 / (3.3)	COPPER	.032 / (0.8)	650F (342C)
192030172	B-T-304	16-14 (1.2-2.0mm <sup>2</sup> )	.330 / (8.4)	.091 / (2.3)	.160 / (4.1)	COPPER	.032 / (0.8)	650F (342C)
192030169	C-T-303	12-10 (3.0-6.0mm <sup>2</sup> )	.330 / (8.4)	.130 / (3.3)	.225 / (5.7)	COPPER	.040 / (1.0)	650F (342C)

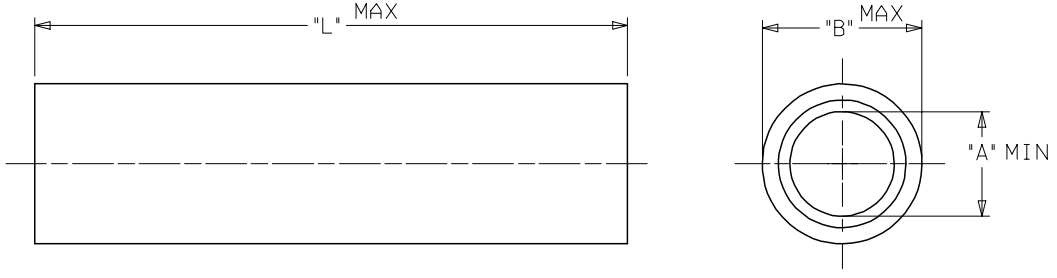

NOTES:  
 1. PLATING: ELECTRO-NICKEL.  
 2. ALL DIMENSIONS IN INCHES/(MM).  
 3. RoHS COMPLIANT

RELEASE FOR PROD  
 EC NO: ETC2007-0146  
 DRW: JLOMASTRO 2006/10/11  
 CHKD: JMACNEIL 2006/10/11  
 APPR: JMACNEIL 2006/10/12

QUALITY SYMBOLS  
  
 DESCRIPTION

	GENERAL TOLERANCES (UNLESS SPECIFIED)	
	mm	INCH
4 PLACES	± .005	± .0004
3 PLACES	± .005	± .010
2 PLACES	± 0.25	± .01
1 PLACE	± 0.3	± .005
ANGULAR		± 1/2°

DRAFT WHERE APPLICABLE MUST REMAIN WITHIN DIMENSIONS

DIMENSION STYLE	
IN/MM	
DRAWN BY	DATE
JLOMASTRO	10/02/06
CHECKED BY	DATE
JMACNEIL	10/02/06
APPROVED BY	DATE
RDEROSS	10/04/06
MATERIAL NO.	SEE CHART

SCALE	DESIGN UNITS	THIRD ANGLE PROJECTION
	INCH	
TITLE		
PARALLEL SPLICE VERSAKRIMP TEMP TERMS		
APPROVED BY		
MOLLEX MOLEX INCORPORATED		
MATERIAL NO.	DOCUMENT NO.	SHEET NO.
SEE CHART	SD-19203-042	1 OF 1
THIS DRAWING CONTAINS INFORMATION THAT IS PROPRIETARY TO MOLEX INCORPORATED AND SHOULD NOT BE USED WITHOUT WRITTEN PERMISSION		