

# Hand Held (1599 Series)

Plastic

Recessed top panel for membrane display or pad...

P.C. card standoffs and vertical card guides molded in...

Flame retardant ABS version includes wear resistant brass bushings...

Flame retardant ABS version includes four machine screws (polystyrene are self-tapping)...

Long life battery door option with our "three snap" location door...

## OTHER KEY FEATURES

- Attractively styled and ergonomically designed for use as a "hand-held" instrument enclosure.
- Lap joint construction provides protection against access of dust and splashing water.
- Extra deep top and ultra shallow base are specifically designed to enhance the aesthetics of the enclosure and provide the user with flexibility and assembly efficiency.
- Designed to meet IP54.
- Flame retardant ABS plastic carries a UL flammability rating of 94 V-O.
- Accessory screws for mounting P.C. boards into standoffs P/N **1593ATS50** (qty. 50), P/N **1593ATS100** (qty. 100).
- Two keyhole knockouts are molded into the inside of the base to facilitate wall mount installation.

### Fire Retardant ABS Plastic

Part Number	See Size Chart	Color	Battery Door	Belt Clip	Shielded
<b>1599BBK</b>	1599B	Black	-	-	-
<b>1599BGY</b>	1599B	Grey	-	-	-
<b>1599RBBK</b>	1599B	Black	-	-	Yes
<b>1599BBKBAT</b>	1599B	Black	Yes	-	-
<b>1599BGYBAT</b>	1599B	Grey	Yes	-	-
<b>1599BBKCP</b>	1599B	Black	-	Yes	-
<b>1599BGYCP</b>	1599B	Grey	-	Yes	-
<b>1599BBKBATCP</b>	1599B	Black	Yes	Yes	-
<b>1599BGYBATCP</b>	1599B	Grey	Yes	Yes	-
<b>1599EBK</b>	1599E	Black	-	-	-
<b>1599EGY</b>	1599E	Grey	-	-	-
<b>1599REBK</b>	1599E	Black	-	-	Yes
<b>1599EBKBAT</b>	1599E	Black	Yes	-	-
<b>1599EGYBAT</b>	1599E	Grey	Yes	-	-
<b>1599HBK</b>	1599H	Black	-	-	-
<b>1599HGY</b>	1599H	Grey	-	-	-
<b>1599RHBK</b>	1599H	Black	-	-	Yes
<b>1599HBKBAT</b>	1599H	Black	Yes	-	-
<b>1599HGYBAT</b>	1599H	Grey	Yes	-	-
<b>1599KBK</b>	1599K	Black	-	-	-
<b>1599KGY</b>	1599K	Grey	-	-	-
<b>1599KBKBAT</b>	1599K	Black	Yes	-	-
<b>1599KGYBAT</b>	1599K	Grey	Yes	-	-

### High Impact Polystyrene

Part Number	See Size Chart	Color	Battery Door
<b>1599BSGY</b>	1599B	Grey	-
<b>1599BSGYBAT</b>	1599B	Grey	Yes
<b>1599ESGY</b>	1599E	Grey	-
<b>1599ESGYBAT</b>	1599E	Grey	Yes
<b>1599HSGY</b>	1599H	Grey	-
<b>1599HSGYBAT</b>	1599H	Grey	Yes
<b>1599KSGY</b>	1599K	Grey	-
<b>1599KSGYBAT</b>	1599K	Grey	Yes

#### Battery Holder Kits

- Kits include all the parts required to install the batteries
- Kit includes the battery holder, wires, divider and foam anti-rattle pad.

Part Number	Battery holder kit for:
<b>BH1AAWKIT</b>	1 AA Cell
<b>BH2AAWKIT</b>	2 AA Cells
<b>BH1AAAWKIT</b>	1 AAA Cell
<b>BH2AAAWKIT</b>	2 AAA Cells
<b>BH3AAAWKIT</b>	3 AAA Cells
<b>BH4AAAWKIT</b>	4 AAA Cells
<b>BS61KIT</b>	1 - 9V Cell

36



#### CANADA

Guelph, Ontario (519) 822-2960  
St. Laurent, Quebec (514) 343-9010

#### USA

Cheektowaga, NY (716) 651-0086



#### EUROPE

Basingstoke, UK +44 1256 812812

#### AUSTRALASIA

Queenstown, SA, Australia +61 8 8240 2244

# Hand Held (1599 Series)

Plastic

Body View

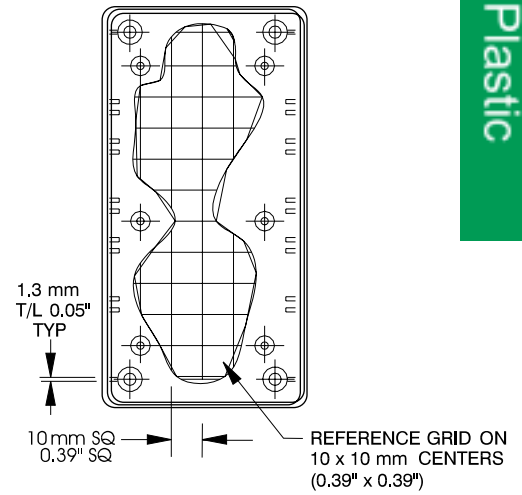
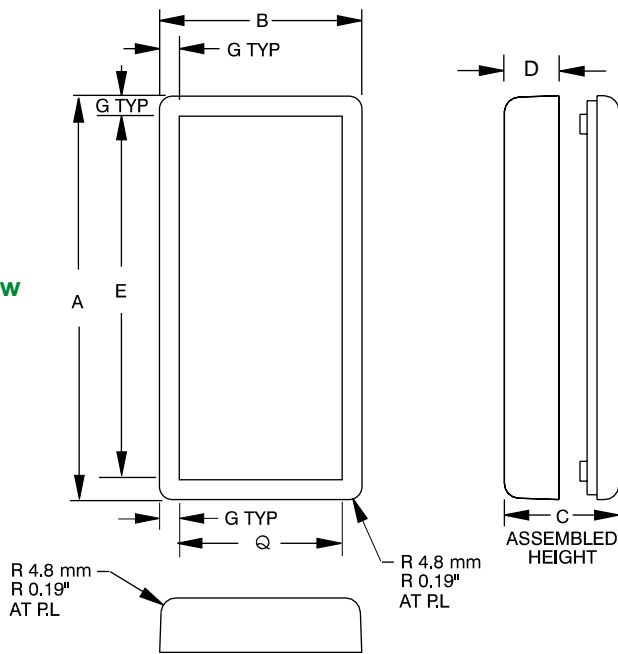

Lid View

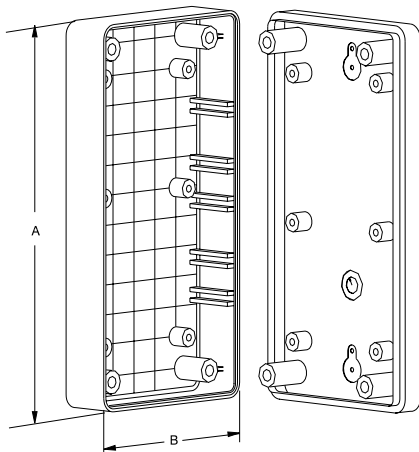
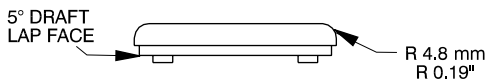
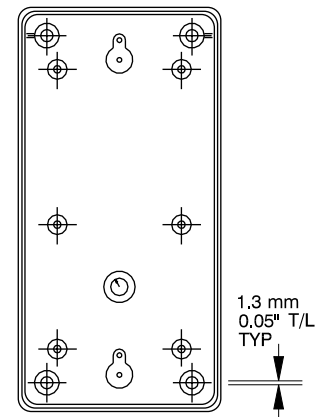
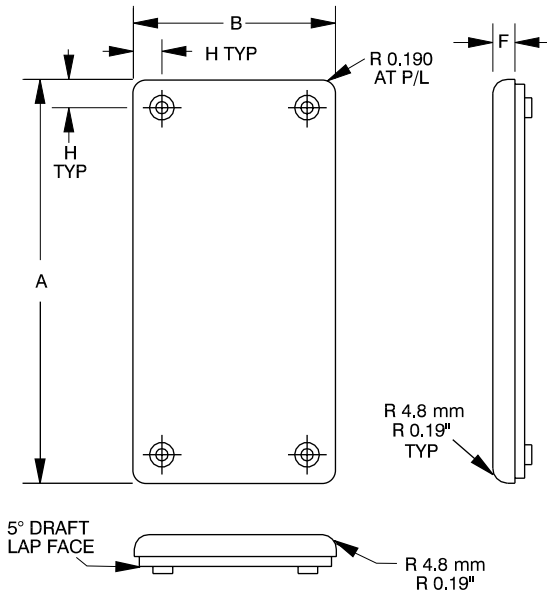

## SIZE CHART

Part Number	Units	Dimensions								
		A	B	C	D	F	G	H	Q	E
1599B	inch	5.12	2.56	0.97	0.69	.28	.24	.36	2.06	4.62
	mm	130	65	25	17.5	7	6	9	52.2	117.2
1599E	inch	6.70	3.35	1.33	1.02	.31	.24	.40	2.81	6.16
	mm	170	85	34	26	8	6	10	71	157
1599H	inch	8.66	4.33	1.73	1.38	.35	.24	.44	3.73	8.06
	mm	220	110	44	35	9	6	11	94.8	204.8
1599K	inch	8.66	5.51	1.58	1.19	.35	.24	.44	4.98	8.11
	mm	220	140	40	30	9	6	11	126	206



**CANADA**  
Guelph, Ontario (519) 822-2960  
St. Laurent, Quebec (514) 343-9010  
**USA**  
Cheektowaga, NY (716) 651-0086

[www.hammondmfg.com](http://www.hammondmfg.com)

**EUROPE**  
Basingstoke, UK +44 1256 812812

**AUSTRALASIA**  
Queenstown, SA, Australia +61 8 8240 2244

# Accessories (1599 Series)

## ACCESSORIES

Plastic



### Replacement Screws for ABS

Machine screw, used in flame retardant ABS 1599B series (ie...with brass inserts).

M3 - 0.5 x 20 mm

**1594MS100** - Package of 100

Machine screw, used in flame retardant ABS 1599E, H & K series (ie...with brass inserts).

M3 - 0.5 x 10 mm

**1591MS100** - Package of 100



### Replacement Screws for Polystyrene

Self-tapping type, used in polystyrene 1599BS series (ie...no brass inserts).

# 4 x 3/4"

**1599BTS100** - Package of 100

Self-tapping type, used in polystyrene 1599ES, HS & KS series (ie...no brass inserts). # 4 x 5/8"

**1598TS100** - Package of 100

### Battery Holder Kits

- Designed for our battery door enclosures.
- Kits include all the parts required to install the battery or batteries.
- Kit includes the battery holder, wires, divider and foam anti-rattle pad.

Part Number	Battery holder kit for:	Fits Battery Door Enclosure Size:
<b>BH1AAWKIT</b>	1 AA Cell	B, E, H & K
<b>BH2AAWKIT</b>	2 AA Cells	B, E, H & K
<b>BH1AAAWKIT</b>	1 AAA Cell	B, E, H & K
<b>BH2AAAWKIT</b>	2 AAA Cells	B, E, H & K
<b>BH3AAAWKIT</b>	3 AAA Cells	E, H & K
<b>BH4AAAWKIT</b>	4 AAA Cells	E, H & K
<b>BS61KIT</b>	1 - 9V Cell	B, E, H & K

Nylon screws for electrical insulation and strength...



High strength nylon clip for belt or pocket...

### Belt or Pocket Clip (for hand held)

Molded from tough nylon, includes 2 nylon screws and mounting template.

Black - **1599CLIP**

Grey - **1599CLIPGY**

### P.C. Board Mounting Screws

Self-tapping type, used for bosses in the 1599 series for P.C. board installation. # 4 x 1/4" (6.4 mm)

**1593ATS50** - Package of 50

**1593ATS100** - Package of 100



### Battery Dividers (for hand held)

Grey ABS plastic panel barriers which insert vertically into the P.C. card guides of the 1599B series.

**1599BD5** - Package of 5

**1599BD100** - Package of 100

Grey ABS plastic panel barriers which insert vertically into the P.C. card guides of the 1599E series.

**1599ED5** - Package of 5

**1599ED100** - Package of 100

Grey ABS plastic panel barriers which insert vertically into the P.C. card guides of the 1599H series.

**1599HD5** - Package of 5

**1599HD100** - Package of 100

