

PRODUCT NUMBER	PITCH
NBxx70x300J0G	5.00 mm

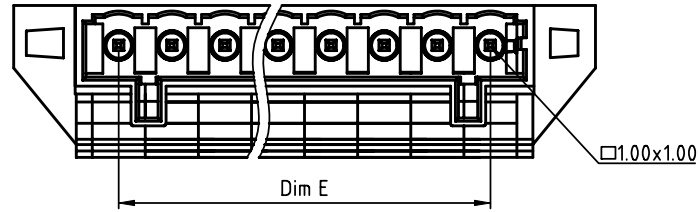

N=Number of poles
 Dim A=Nx5.0+3.0
 Dim B=Nx5.0+3.2
 Dim C=Nx5.0+8.8
 Dim D=Nx5.0+14.8
 Dim E=(N-1)x5.0

PART NO.: NB xx 7 0 x 3 00J0 G

Solid block	0	Black (RAL9005)	RoHS compliant (lead<4%) In copper Alloy
No. of poles	2	Red (RAL3001/D)	
02	2 poles	3	Orange(RAL2011/P)
03	3 poles	4	Yellow(RAL1018/A)
...	...	5	Green(RAL6018/T)
24	24 poles	6	Blue (RAL5015/A)
		8	Grey(RAL7035/D)
		9	White(RAL1102)
		C	Green(RAL6018/U)

POLES	Tolerance
2p-6p	±0.20
7p-12p	±0.25
13p-18p	±0.30
19p-24p	±0.40

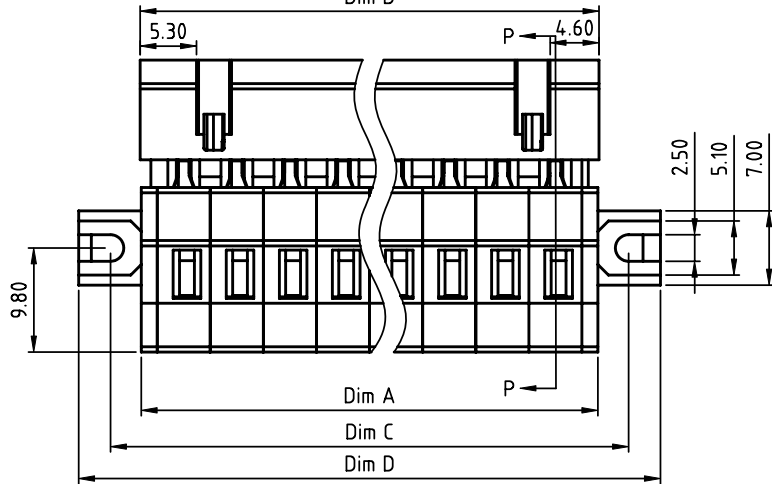

Material:

- Item①Top body: Thermoplastic (UL94 V-0)
- Item②Bottom body: Thermoplastic (UL94 V-0)
- Item③Male contact pin: Brass Tin plated
- Item④Spring clamp: Stainless steel

Electrical cULus

- Voltage rating: 300V
- Current rating: 8A
- Wire range:
 - Solid wire(AWG): 12-28
 - Stranded wire(AWG): 12-28
 - Wire strip length: 8-9mm
- Withstanding Voltage: 1.6KV
- Operating temperature: -40°C to +115°C
- Safety Approval:

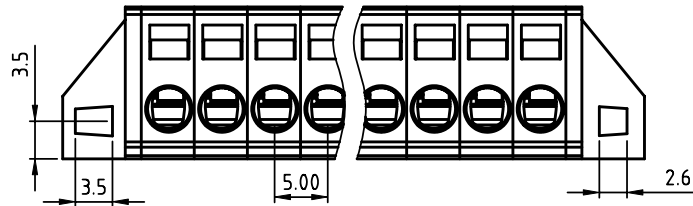
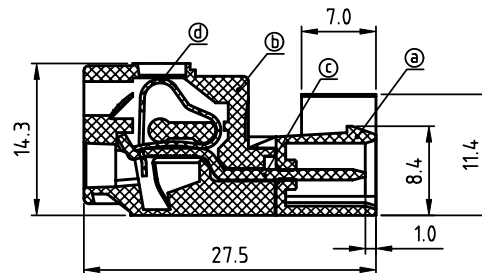

mat'l. code		surface ASME Y14.5	tolerance ASME Y14.5	projection 	product family TERMINAL BLOCK
ltr	ecn no	dr	date	MM	title TERMINAL BLOCK SPRING CLAMP, PLUGGABLE PLUG, MALE CONNECTOR W/FLANGE, 100% PROTECTED AGAINST MISMATING
tolerances unless otherwise specified					
angles	X.±0.5		scale		
	X.X±0.3		FCI		
X°±1°	X.XX±0.1		dwg no NBxx70x300J0G		
dr	EVIN ZHONG	051714	sheet 1 of 1 size A4		
enr	EVIN ZHONG	051714	type CUSTOMER Drawing		
chr	HANKE FENG	051714			
appd	SHI JUN	051714			
sheet index	revision sheet	A	1		